



Flat 15, Barons Court Earls Meade, Luton, LU2 7EY

A well presented one bedroom ground floor flat situated in the sought after of Barons Court in Earls Meade. Offered in immaculate condition throughout and available immediately on an unfurnished basis.

The property comprises a bright and spacious living area, a well proportioned double bedroom, a fitted kitchen and a clean well designed bathroom. Finished to a high standard, the flat is ideal for professionals seeking a comfortable and convenient home.

Further benefits include secure undercroft parking and access to a residents' gym.

Ideally located within close proximity to Luton station, offering excellent transport links and just a short walk from Wardown Park, providing beautiful green open space.

Early viewing is highly recommended, Call Nova Estate Agents now to book a viewing.

£900 Per month

- Nova Estate Agents
- 1 Bedroom Ground Floor Flat
- Available Now
- Unfurnished
- Immaculate Condition
- Walking Distance Of The Train Station
- Round The Corner From Wardwon Park
- Access To The Communal Gym
- Undercroft Secure Allocated Parking
- Press Play Button For 360° Walkaround Tour

Approx Gross Internal Area
40 sq m / 431 sq ft

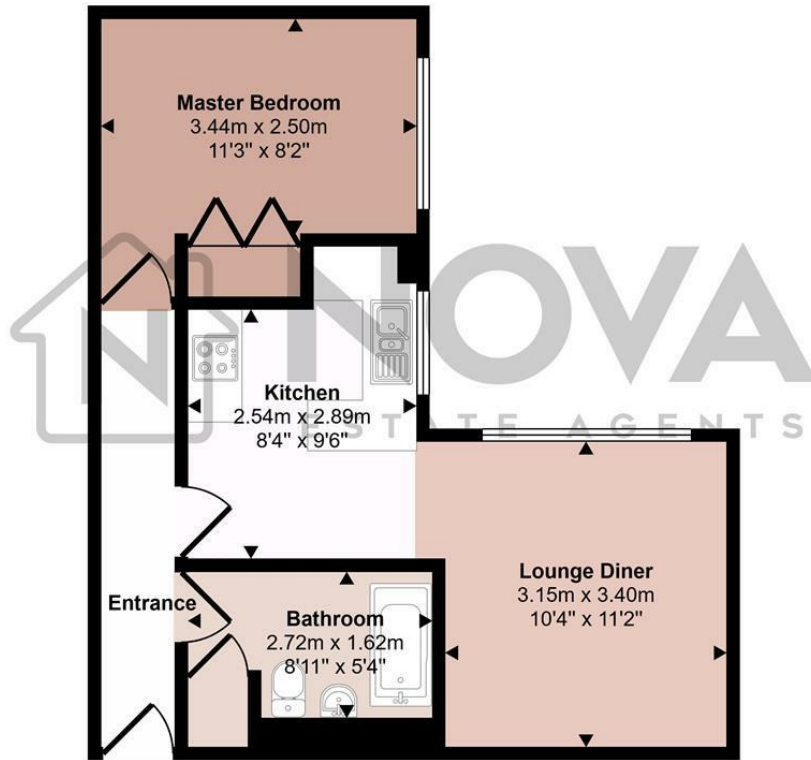

Floorplan

This floorplan is only for illustrative purposes and is not to scale. Measurements of rooms, doors, windows, and any items are approximate and no responsibility is taken for any error, omission or mis-statement. Icons of items such as bathroom suites are representations only and may not look like the real items. Made with Made Snappy 360.

Energy Efficiency Rating		Current	Potential
Very energy efficient - lower running costs			
(92 plus) A			
(81-91) B			
(69-80) C			
(55-68) D		62	70
(39-54) E			
(21-38) F			
(1-20) G			
Not energy efficient - higher running costs			
England & Wales	EU Directive 2002/91/EC		